



OZ1BCA-MR



Standards:

This product meets or exceeds
 OSHA 1926 Subpart M
 OSHA 1910.140
 ASME Z359.1
 ASME A10.32-2012
 standards for fall protection.

BEAM CLAMP USA

Features

- Fall protection 400lbs
- Robust all-steel fully-welded construction
- Super-quick adjustment to most I-Beams (see measurements below)
- ROHS compliant zinc plated finish
- Permanent engraved load rating
- Secondary rod lock nut
- Made in USA
- Individual test certificate & serial number

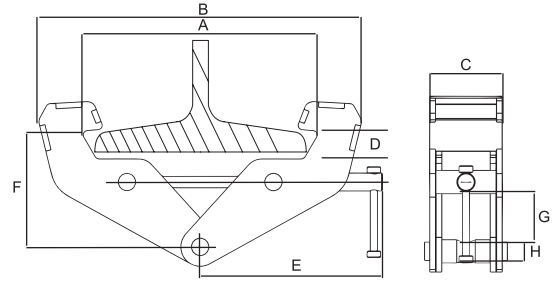

	OZ1BCA-MR	OZ2BCA-MR	OZ3BCA-MR	OZ5BCA-MR	OZ10BCA-MR
Capacity (tons)	1	2	3	5	10
Fall Protection (lbs)	400	400	400	400	400
Dimensional Information (in)	A	3-8	3-8	3.5-13	3.5-13
	B	14.75	14.75	20.5	20.5
	C	2.51	2.91	3.94	4.41
	D	0.9	0.9	1.5	1.5
	E	9.5	9.5	11	11
	F	4.75-5.75	4.75-5.75	7.5-9	7.5-9
	G	1.75	1.75	2.5	2.5
	H	.75	.875	.975	1.125
Net Weight (lbs)	9	11	22	26	39

Dimensions and illustrations are for reference only and subject to change without notice.



OZ1PBTA-MR
 [PATENTED]

Standards:

This product meets or exceeds
 OSHA 1926 Subpart M
 OSHA 1910
 ASME Z359.1-2007
 ASME A10.32-2012
 standards for fall protection.

PUSH BEAM TROLLEY USA

Features

- Fall protection 400 lbs.
- Fast and easy width adjustments
- Built-in width adjustment indicator
- Universal wheel tread fits most I, S, and W-Beams
- Premium double-sealed ball bearings
- ROHS compliant zinc plated finish
- Anti-drop plates
- Glow in the dark decals
- Ships fully assembled
- Made in USA
- Individual test certificate & serial number

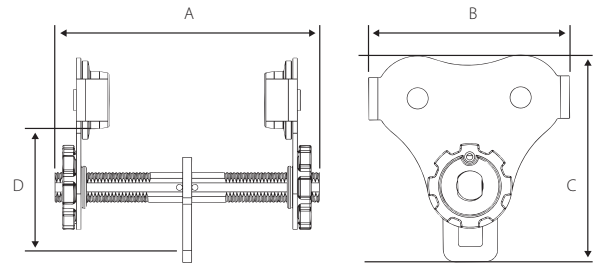

	OZ05PBTA-MR	OZ05PBTA-MR-12	OZ05PBTA-MR-16	OZ1PBTA-MR	OZ1PBTA-MR-12	OZ1PBTA-MR-16
Capacity (tons)	5	5	5	1	1	1
Adjustable flange width (in)	2.52-8.00	2.52-12.00	2.52-16.00	2.75-8.00	2.75-12.00	2.75-16.00
Max Flange Thickness (in)	1.12	1.12	1.12	1	1	1
Product dimensions	A	12.25	15.5	19.5	15.5	19.5
	B	8.3	8.3	8.3	10.2	10.2
	C	8.5	8.5	8.5	9.8	9.8
	D	5	5	5	5.5	5.5
Minimum radius curve (ft)	2.75	2.75	2.75	3.35	3.35	3.35
Net weight (lbs)	16	19	20	26	30	31



Dimensions and illustrations are for reference only and subject to change without notice.

See wheel & bail dimensions page 18

