

OZ5BCA

**Standards - ASME/ANSI B30.16,  
BTH-1 Design Category B Service  
Class 0**



# BEAM CLAMP USA



## Features

- Robust all-steel fully-welded construction
- Super-quick adjustment to fit most I-Beams (see measurements below)
- ROHS compliant zinc plated finish
- Permanent engraved load rating
- Individual test certificate and serial number
- Made in USA

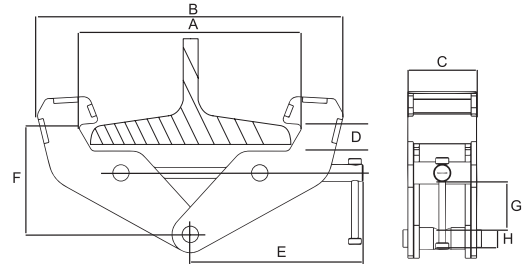

	OZ1BCA	OZ2BCA	OZ3BCA	OZ5BCA	OZ10BCA
Capacity (tons)	1	2	3	5	10
A	3 – 9	3 – 9	3.5 – 13	3.5 – 13	3.5 – 13
B	14.75	14.75	20.5	20.5	22
C	2.51	2.91	3.94	4.41	4.72
D	0.9	0.9	1.5	1.5	1.5
E	9.5	9.5	11	11	11.5
F	4.75 – 5.75	4.75 – 5.75	7.5 – 9	7.5 – 9	5.5 – 9.375
G	1.75	1.75	2.5	2.5	4
H	.75	.875	.975	1.125	1.625
Net Weight (lbs)	9	11	22	26	39

Dimensions and illustrations are for reference only and subject to change without notice.



OZ1PBTA  
[PATENTED]



**Standards - ASME/ANSI  
B30.17**



# PUSH BEAM TROLLEY USA



## Features

- Fastest adjusting trolley requiring no tools to install
- Lightweight robust construction
- ROHS compliant zinc plated finish
- Glow in the dark decals
- Universal wheel tread fits most I, S, and W-Beams
- Precision ball bearing trolley wheels
- Side plates protect trolley wheels
- Anti-drop plate
- Individual test certificate and serial number
- Made in USA

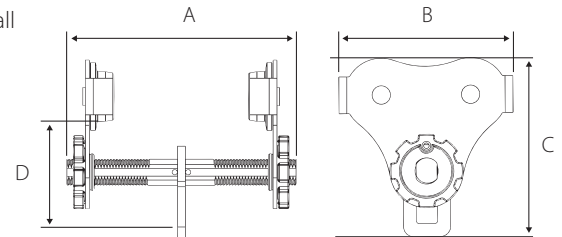

	OZ05PBTA	OZ05PBTA-12	OZ05PBTA-16	OZ1PBTA	OZ1PBTA-12	OZ1PBTA-16	OZ2PBTA	OZ3PBTA
Capacity (tons)	5	5	5	1	1	1	2	3
Adjustable flange width (in)	2.52-8.00	2.52-12.00	2.52-16.00	2.75-8.00	2.75-12.00	2.75-16.00	3.75-8.00	3.75-8.00
Max Flange Thickness (in)	1.12	1.12	1.12	1	1	1	1.5	1.75
Product dimensions								
A	12.25	15.5	19.5	11	15.5	19.5	14	14
B	8.3	8.3	8.3	10.2	10.2	10.2	12	15.4
C	8.5	8.5	8.5	9.8	9.8	9.8	11.9	14
D	5	5	5	5.5	5.5	5.5	8.5	9.87
Minimum radius curve (ft)	2.75	2.75	2.75	3.35	3.35	3.35	4.5	5
Net weight (lbs)	16	19	20	26	30	31	45	80

**See wheel and bail dimensions on page 18**

Dimensions and illustrations are for reference only and subject to change without notice.

